

WirePro *Advantage Plus*

Operation Manual



POWERHOUSE

INTRODUCTION:

Congratulations on the purchase of your new WirePro *Advantage Plus*, the modern, practical and reliable punch and binding machine. Your WirePro *Advantage Plus* was designed with premium quality components to guarantee an effortless and easy bind, as well as many years of trouble - free service.

IMPORTANT:

We recommend that you take a few minutes to familiarize yourself with the functions of your new WirePro *Advantage Plus*. You will find that with just a little practice anyone can achieve professional results.

WARRANTY:

Your WirePro *Advantage Plus* has a warranty of one year from its purchase date. In the event of a manufacture's defect, your distributor (at his option) will repair or replace it. Important: this warranty does not cover damages due to improper use or mistreatment of the unit, including any extraordinary event leading to the damage of the machine, whether it is reversible or not.

If the WirePro *Advantage Plus* is not operating properly, first follow the corrective actions above. If the problem persists, please contact the distributor that you purchased it from for instructions. Please have your machine's serial number and the purchase date ready. If the machine must be returned to your distributor, it is your responsibility to properly pack and ship it, as any damaged incurred during its transportation is not covered by this warranty.

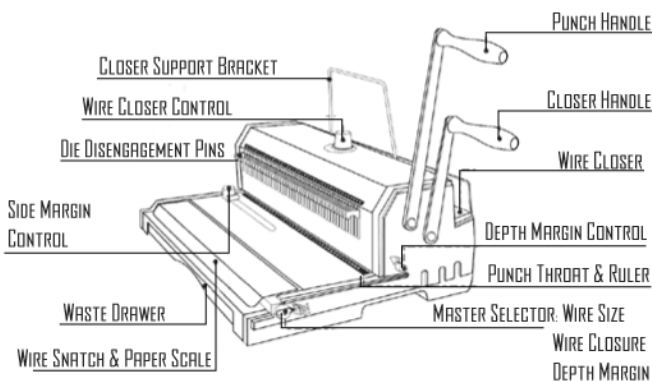

ASSEMBLY

Place your new WirePro *Advantage Plus* on top of a sturdy working table.

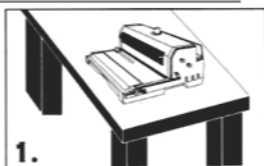

Remove the screw from punching axle slide the punch handle (the Longer one) in a vertical position onto the punching axle.



To set-up the closer handle repeat above steps with closer axle & handle (the shorter one)

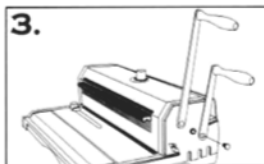

SET-UP

1. Read the master selector to determine the correct: Depth Margin, Wire Size & Wire Closure

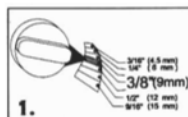

2. Set Margin Control to the color determined depth margin. (color indicated on master selector should match color on margin control)

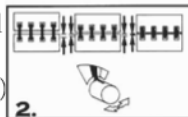

3. Set wire closer control to the determined wire closure size. (size indicated on master selector should match size on wire closer control)

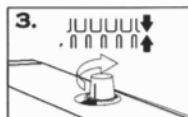

4. Read the determined wire size and set aside

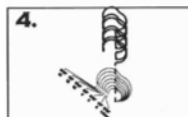

Insert your full unbound document into Wire Holder.

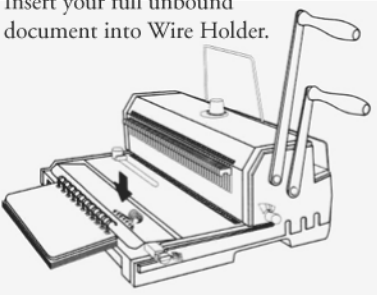

TIPS

For right depth margin, the margin control knob should be rounded to original level after punch to set.

Use some waste paper first to test to see if all set-up is correct.



PUNCHING

Move side margin control to proper sheet & cover size
note there are different side margins for 11" sheets & their 11-1/4" covers.

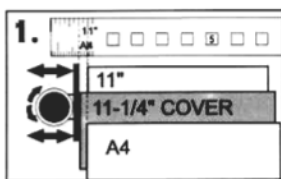

Pull out disengagement pins for partially covered holes.

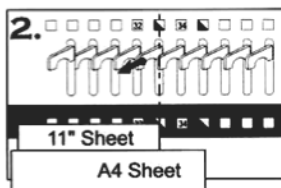

Insert sheets and pull handle forward to punch.

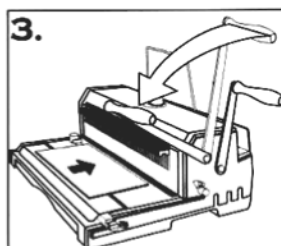

TIPS

Maximum single punching: 20 sheets of 20 lbs or 70-80 g/m paper.
Comfortable single punching: 12-15 sheets of 20 lbs or 70-80 g/m paper. Punch inner sheets and cover separately as side margin may vary. Realign (center) margins for oversize covers.

INSERTING

Insert preselected wire into wire snatch

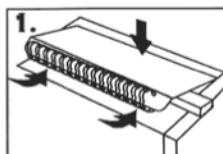

Insert document from last pages to first pages then insert front cover. The back cover should be inserted last with inside facing up

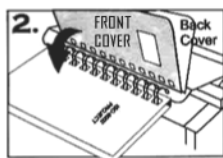

Take out inserted document from wire holder to close the wire.

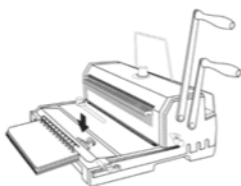
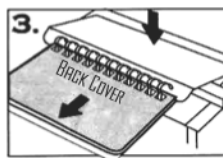

TIPS

The seam of closed wire should be inside the book. Follow step No. 2 instruction for best results

CLOSING

Put inserted document into wire closer.

The wire element must stand horizontally at the bottom of closer.

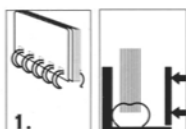

Pull closer handle forward to close.

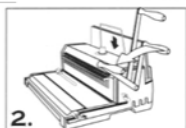

Take out document and turn back cover over. The binding is now completed.



Raise up closer support bracket to hold document

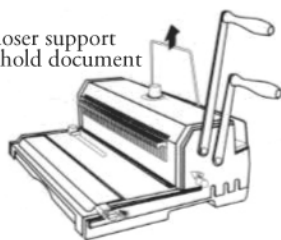

TIPS

The seam of closed wire should be just touching. Slightly adjust the closer control for an under-closed or over-closed seam,



Properly closed

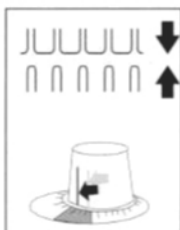

Under closed. Adjust control clockwise a few grids.

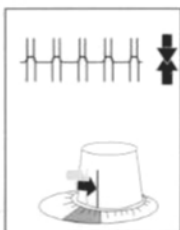

Over Closed. Adjust control counter-clockwise a few grids.

TECHNICAL INFORMATION

WIREPRO *Advantage Plus*

3:1 PITCH







2:1 PITCH

PUNCHING LENGTH	14" =	40 HOLES
	LEGAL =	38 HOLES
	A4 =	34 HOLES
	11" =	32 HOLES
	8.5" =	25 HOLES
	A5 =	24 HOLES





	14" =	27 HOLES
	LEGAL =	26 HOLES
	A4 =	23 HOLES
	11" =	21 HOLES
	8.5" =	16 HOLES
	A5 =	16 HOLES

BINDING CAPACITY

3:1

20	3/16"	4.5	
30	1/4"	6	
50	5/16"	8	
60	3/8"	9	
80	7/16"	10	
100	1/2"	12	
120	9/16"	15	

2:1

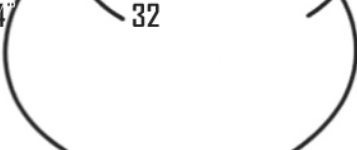
140	5/8"	16	
160	3/4"	19	
190	7/8"	22	
220	1"	25	
280	1-1/4"	32	



Advanced Document Systems & Supply, Inc.
 PHONE: 800-808-2377 FAX: 888-237-7329
www.adss.net