

(3) Adjusting Back Margin (B)(B+C)(X)(P)

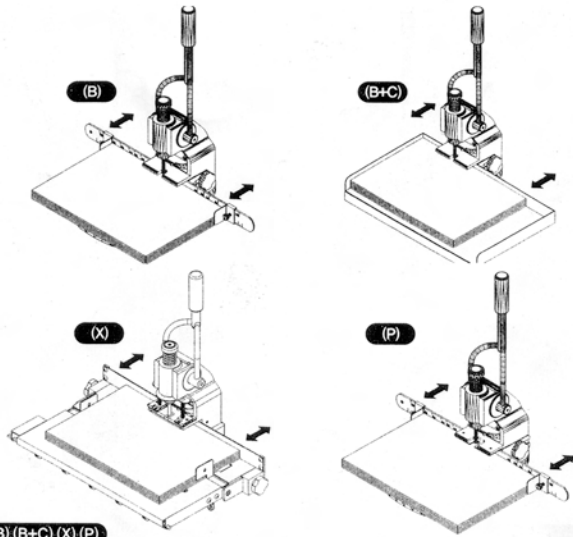

For adjusting back margin, loosen the back margin adjusting screw (8) and adjust Scale Block (6) (B)(P), Table (6) (B+C), Back Margin Guide Plate (2) (X) to the proper position and fasten the screw. In this time, make sure the scale (10) of both sides be same.

(4) Setting the hole positions with table stoppers (X)

Adjust the pitch stoppers to the proper positions of holes and fasten the screws of stoppers (8).

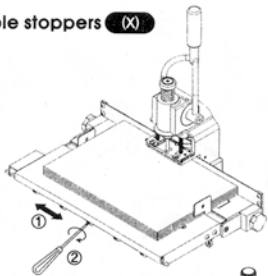

(5) Moving table and punching

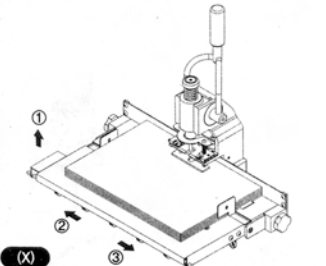

Move table to the left and slide the table to the right hand. And punch the first hole at the first stop. For the next punching lift Table Lever (2) and slide the table to the right and release the lever (2). At the next stop punch the second hole. Repeat this job to the end.

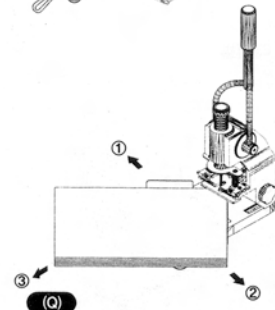

Place the booklet to the edge of the triangle table, and punch the first hole to the left and punch hole. And slide the table to the right, punch the next hole. Then, pull the table and punch the last hole.

(6) 80mm distance 4 holes (B+C)

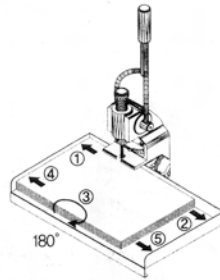

Place the booklet the left end of the table (6) and punch the first hole. And then move the booklet the left end of the table and punch the second hole. After punching 2 holes, reverse the booklet. And repeat the previous job of punching 2 holes. With the above job you will have 4 holes.

5. Maintenance

(1) Replacing drill pin

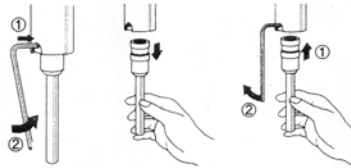

(B)(B+C)(X)(Q)
Loosen drill pin replacement screw (3) with L wrench (20). Take off the used drill pin and replace new drill pin (4) and then tighten the screw (3).

(P)

In the case of normal drill pin (φ3.0 - 8.0mm), follow the above procedure. In case of half circle cutter drill pin (3), loosen the screw (3) on the adaptor while press down the operation arm (1), and adaptor will be dismantled. Replace a new one (3) and fasten the screw.

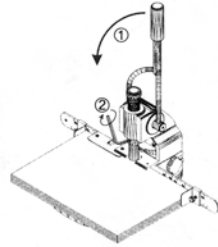

(2) Adjusting the height of drill pin (B)(B+C)(X)(Q)(P)

Turn Stroke Adjuster (2) right and left for the end of drill pin (4) penetrating the pad 0.5mm deep when pushing down Operation arm (1) to the lowest point.

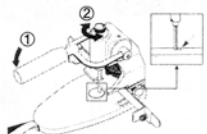

(3) Using Plastic Pad (B)(B+C)(X)(Q)(P)

If you drill onto only one side of punching pad (5) (2), you get worse punching result and shorten drill pin's life. (4) Therefore, rotate punching pad (5) (2) and replace it often. Or replace with new one. (B, B+C, Q, P : Disc, X : Square)

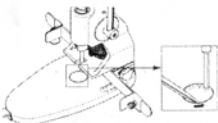

(4) Discharging the chip box (B)(B+C)(X)(Q)(P)

The paper chips are ejected to chip box (9) on the back. You can take it off and empty chip box. Then, put it again on the back.

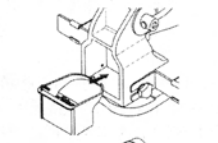

(5) Fixing Band (B)(B+C)(Q)(P)

For the safety hold the operation arm (1) down with fixing band (11) while not using.

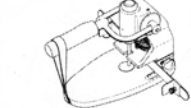

AD Mega Duty SS 1 Hole Punch

OWNER'S MANUAL

Before operating the unit, please read this manual thoroughly and retain it for the future reference.

MODEL : Filepecker - I(B)
Filepecker - I(B+C)
Filepecker - I(X)
Filepecker - I(Q)
Filepecker - I(PLUS)

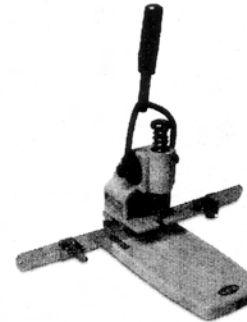

Filepecker - I(B)

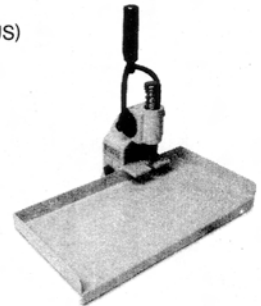

Filepecker - I(B+C)

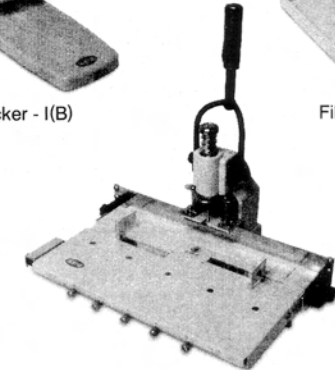

Filepecker - I(X)

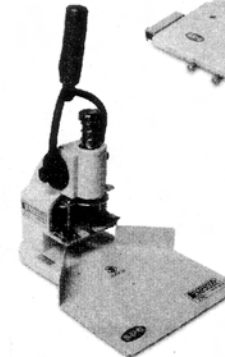

Filepecker - I(Q)

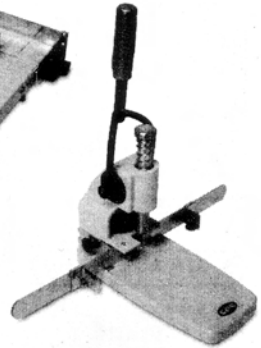

Filepecker - I(PLUS)

*The specifications and constructions of the unit are subjected to change without notice for the improvement.

1. Identifying the parts

Part No.	Part Name	FP - I(B)	FP - I(B+C)	FP - I(X)	FP - I(Q)	FP - I(P)
1	Operation Arm	○	○	○	○	○
2	Stroke Adjuster	○	○	○	○	○
3	Drill Pin Replacement Screw	○	○	○	○	○
4	Drill Pin	○	○	○	○	○
5	Punching Pad (Disc)	○	○	○	○	○
6	Scale Bolck	○	○	○	○	○
7	Side Guide	○	○	○	○	○
8	Back Margin Adjuster	○	○	○	○	○
9	Chip Box	○	○	○	○	○
10	Back Margin Scale	○	○	○	○	○
11	Fixing Band	○	○	○	○	○
12	Body	○	○	○	○	○
13	Drill Pin for Half-circle cutter(Φ20mm)				○	
14	Paper Presser			○	○	
15	Paper Presser Release Pin			○	○	
16	Table		○	○	○	
17	Paper Presser Plate			○	○	○
18	Pitch Stopper			○	○	
19	Wheel			○	○	
20	Table Lever			○	○	
21	Shaft Spring	○	○	○	○	○
22	Back Margin Guide Plate			○	○	
23	Paper Presser Spring			○	○	

Part No.	Part Name	FP - I(B)	FP - I(B+C)	FP - I(X)	FP - I(Q)	FP - I(P)
25	Punching Pad (Square)			○	○	
26	L Wrench	○	○	○	○	○
27	Drill Pin (Φ6.0mm)	○	○	○	○	○

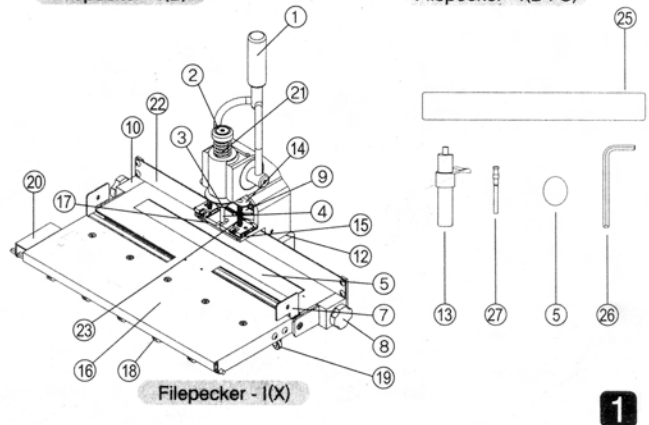
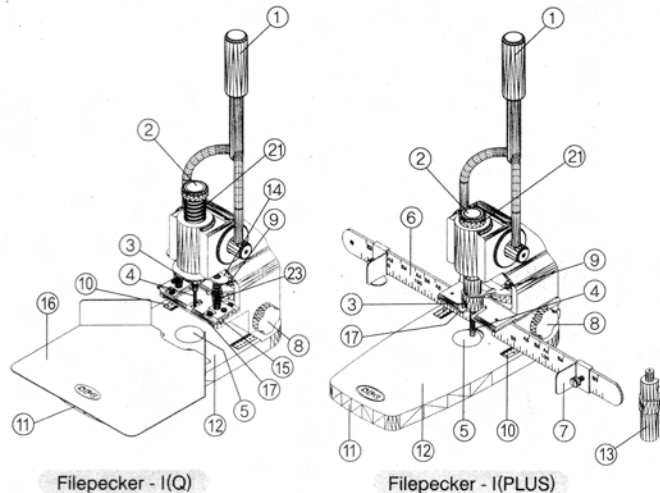
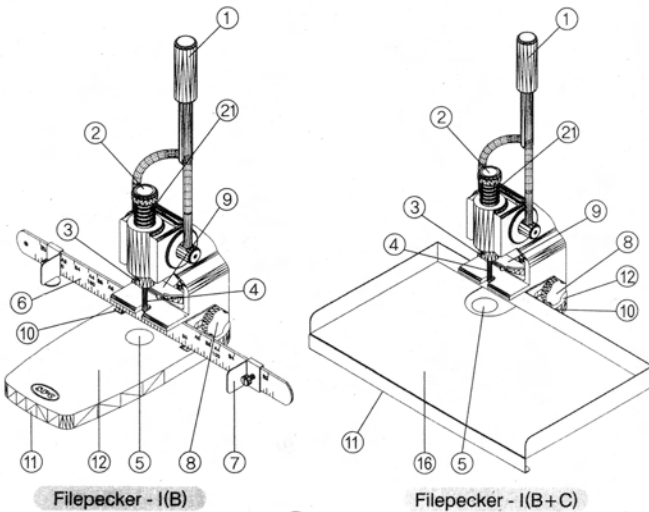

2. SPECIFICATION

	FP - I(B)/(B+C)	FP - I(X)	FP - I(Q)	FP - I(PLUS)
Punching Capacity	30mm (300 sheets, 80gr/m ²)			
Hole Diameter	3.0-8.0mm (LS Type : 3.0mm-10.0mm)		3.5mm	3.0-8.0mm, 20.0mm(Optional)
Back Margin	0-35.0mm	6.0mm-33.0mm	0	0-12.0mm
Paper Size	Max. 365mm Longitudinal			
Paper Feed	Manual			
Weight	3.6kg/4.6kg	6.5kg	3.4kg	3.6kg
Dimensions	440W*310D*210H 380W*310D*210H	450W*315D*210H	200W*310D*210H	440W*310D*210H

3. Cautions! To read before use

- Keep fingers away from drill pin. It is very sharp.
- Make sure clips and staples are removed from the documents before punching or drill pin can be damaged.
- If the drill pin gets dull or it gets hard to punch, the drill pin must be worn out. In this case drill pin should be replaced with new one.

4. How to operate

(1) Placing the booklet in position and adjusting Side Guides

(B) For punching 2 holes place the booklet to the center of Scale 6 and push both side guides 7 to the booklet, move side guides 7 to the distance of half of the desired hole distance and tighten the screws on the scale. Place the booklet to the left end and punch once. Move the booklet to the right end and punch one more time. With this, you can have 2 holes.

(X) Place the booklet on the table and push the side guides 7 to the booklet, and the booklet will be centered automatically.

(P) Before punching, adjust side guides 7 to the position on the scale 6 indicating the proper paper size.

(2) Pressing paper presser (X)(Q) and paper press plate (P)

(X)(Q) After placing the booklet to the proper position and press the paper presser 14. And punch. After punching, press the release pin 15 and take out the booklet.

(P) In punching normal size (Φ3.0 - 8.0mm) hole, use the paper presser plate 17. In punching half-circle shaped hole (Φ20mm), switch paper press plate as shown in the figure.